

Fixer les attaches sur la façade et clipsées sur le tiroir.
Fix the front brackets and clip them on the drawer.

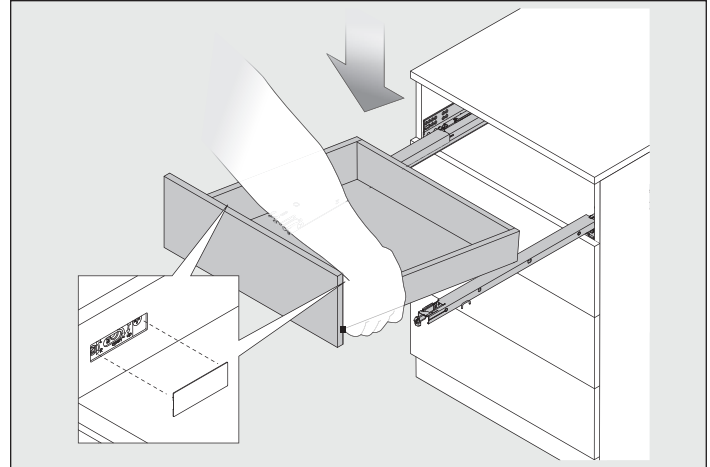

Tirer les coulisses, poser le tiroir dessus et refermer pour le clipser.
Extend the slides, put the drawer on them and close to clip it.

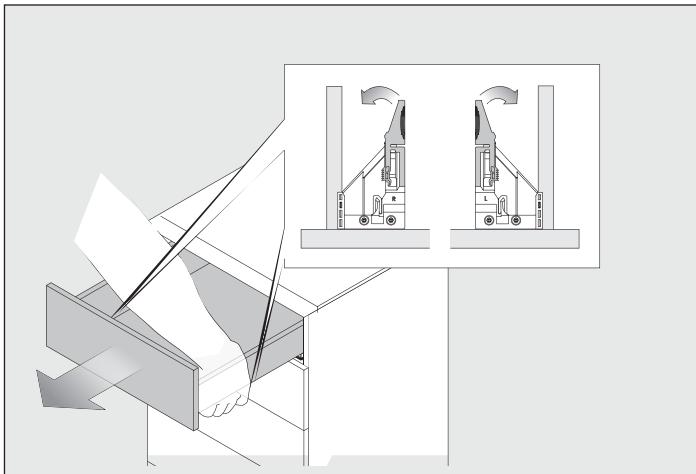

Enlèvement du tiroir sans outils.
Drawer removal, without tool.

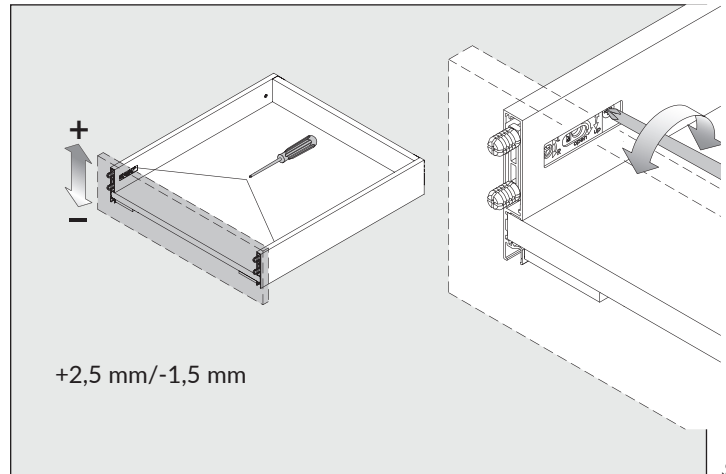

+2,5 mm/-1,5 mm

Réglage de la hauteur de la façade
Drawer front height adjustment

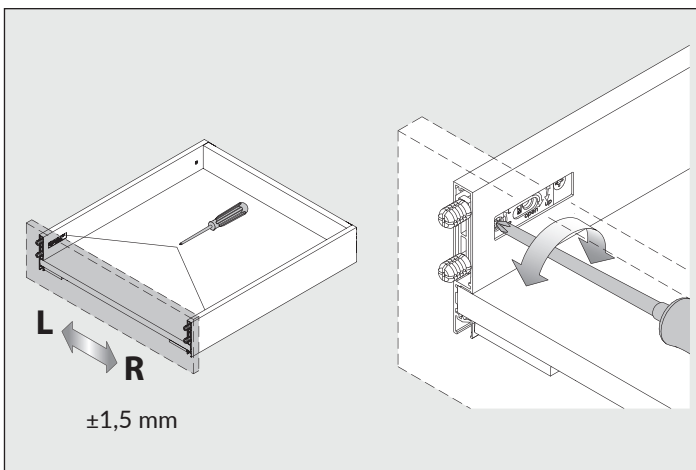

±1,5 mm

Réglage latéral, les deux côtés doivent être ajustés
Lateral adjustments, adjust both sides.

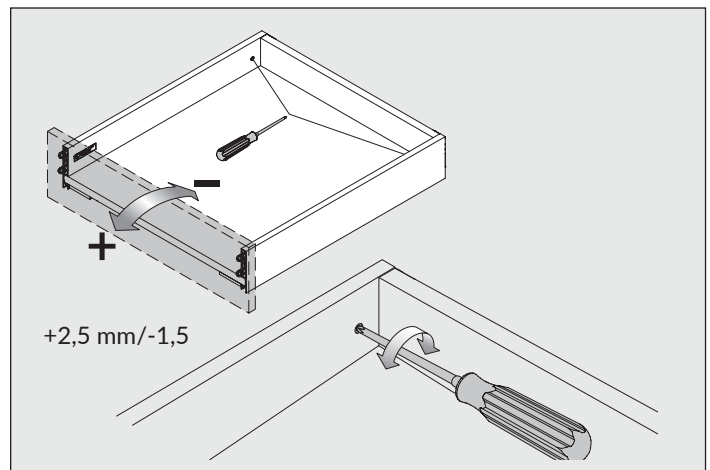

+2,5 mm/-1,5

Réglage de l'inclinaison
Tilt adjustment