

Configuration 1 seul cadre One frame configuration

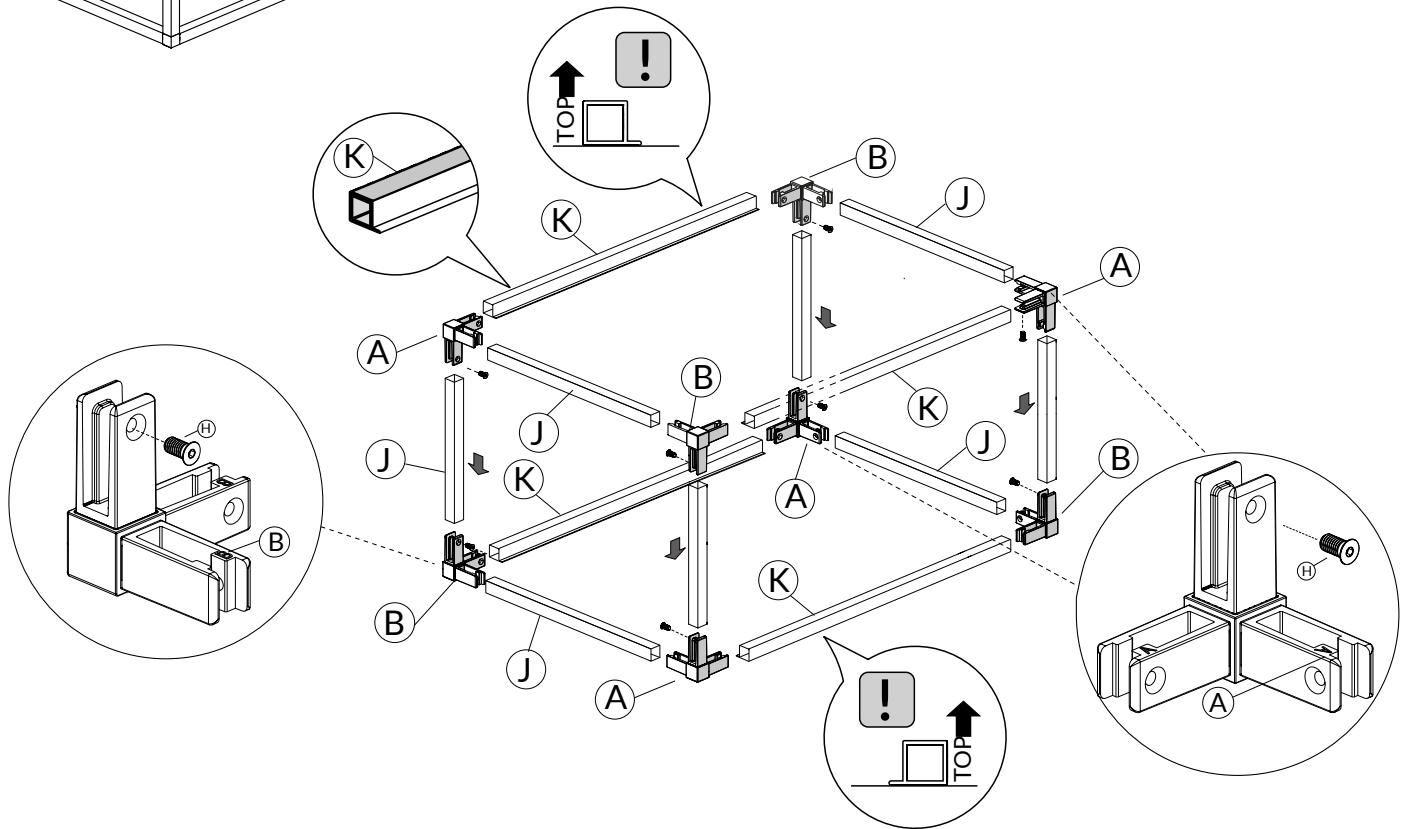

A	CON-FLO-3D-TYPEA-NM
B	CON-FLO-3D-TYPEB-NM
C	CON-FLO-4D-TYPEC-NM
D	CON-FLO-4D-TYPED-NM
E	GAB-FLO
F	EQU-FLO-FIXMUR
G	CON-FLO-5D-NM
H	BOM-FLO-NM
J	PRO-FLO-TYPEA-NM
K	PRO-FLO-TYPEB-NM

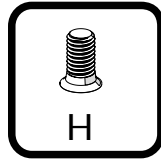
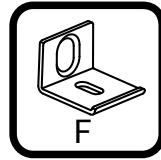
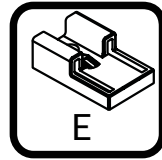
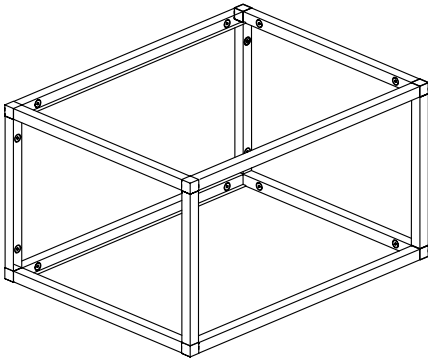
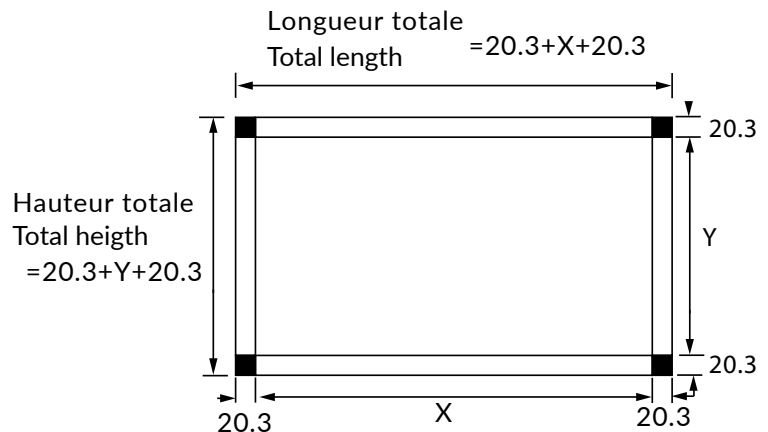

Configuration avec 2 cadres
2 frames configuration

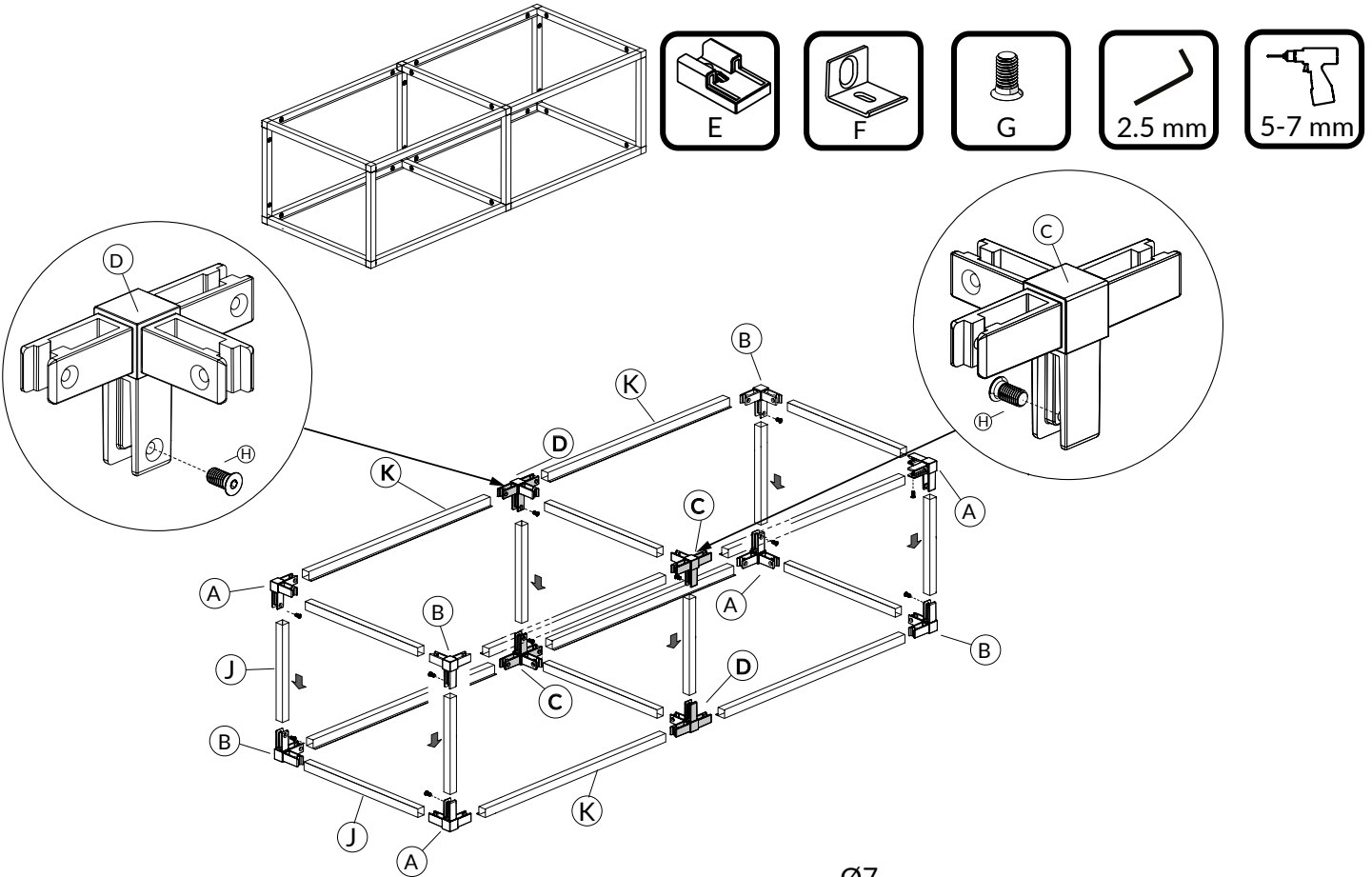

Ø7

Longueur totale
Total length = 20.3+X+20.3+W+20.3

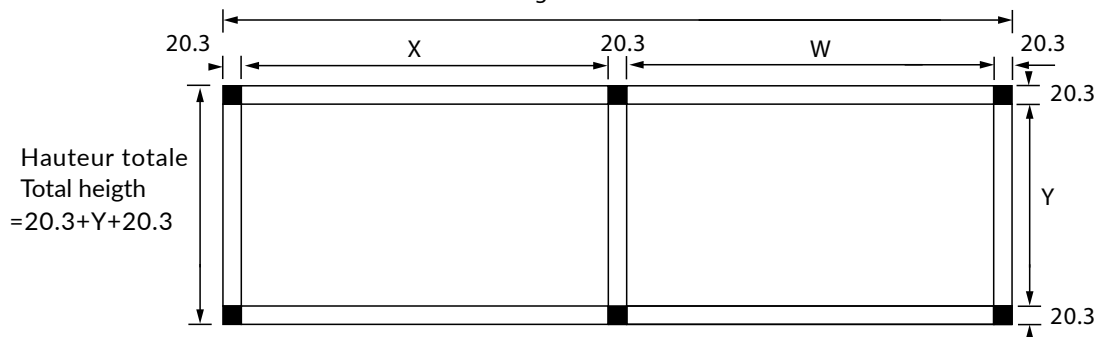

A CON-FLO-3D-TYPEA-NM

B CON-FLO-3D-TYPEB-NM

C CON-FLO-4D-TYPEC-NM

D CON-FLO-4D-TYPED-NM

E GAB-FLO

F EQU-FLO-FIXMUR

G CON-FLO-5D-NM

H BOM-FLO-NM

J PRO-FLO-TYPEA-NM

K PRO-FLO-TYPEB-NM

Configuration avec 3 cadres

3 frames configuration

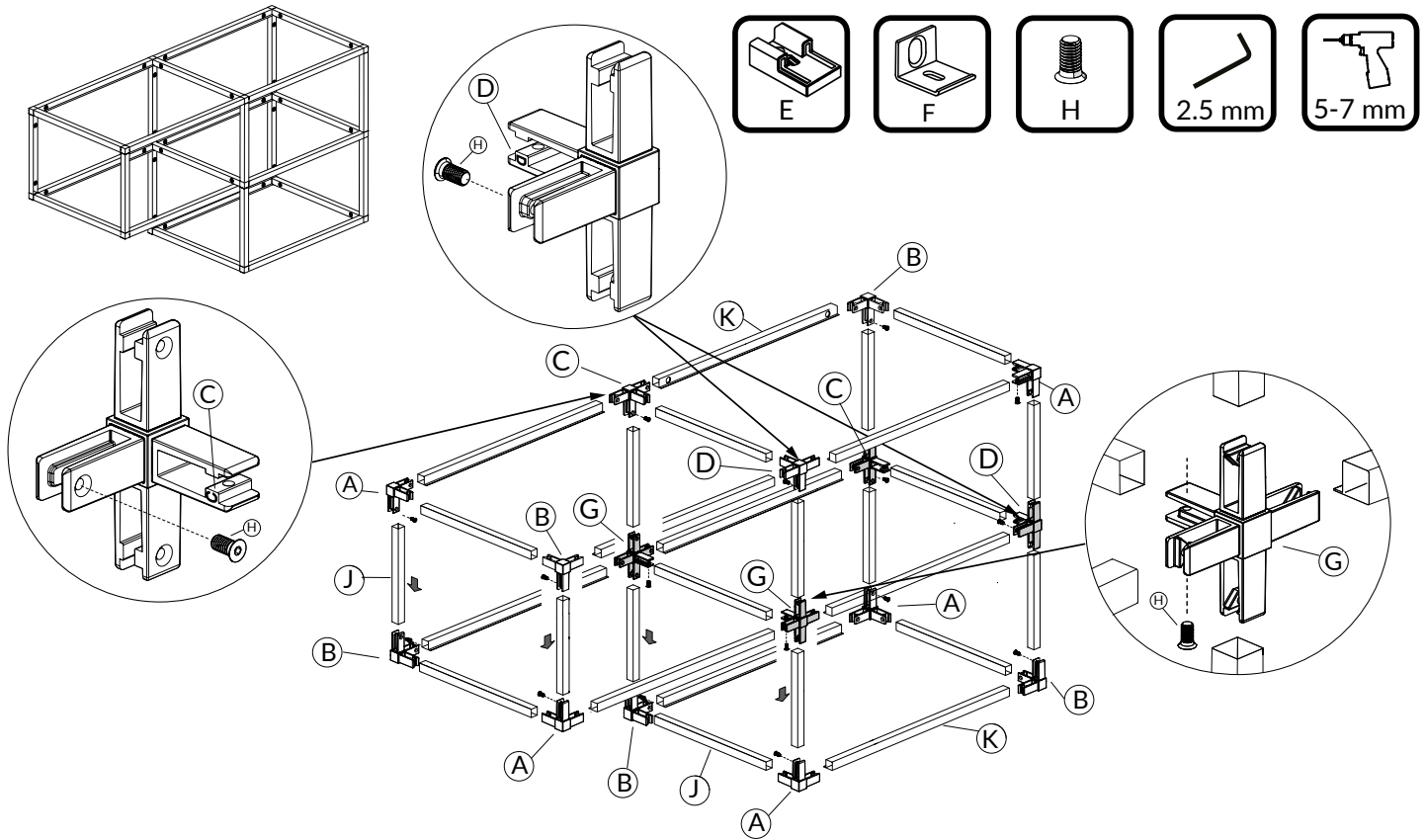

Longueur totale = 20.3+X+20.3+W+20.3
Total length

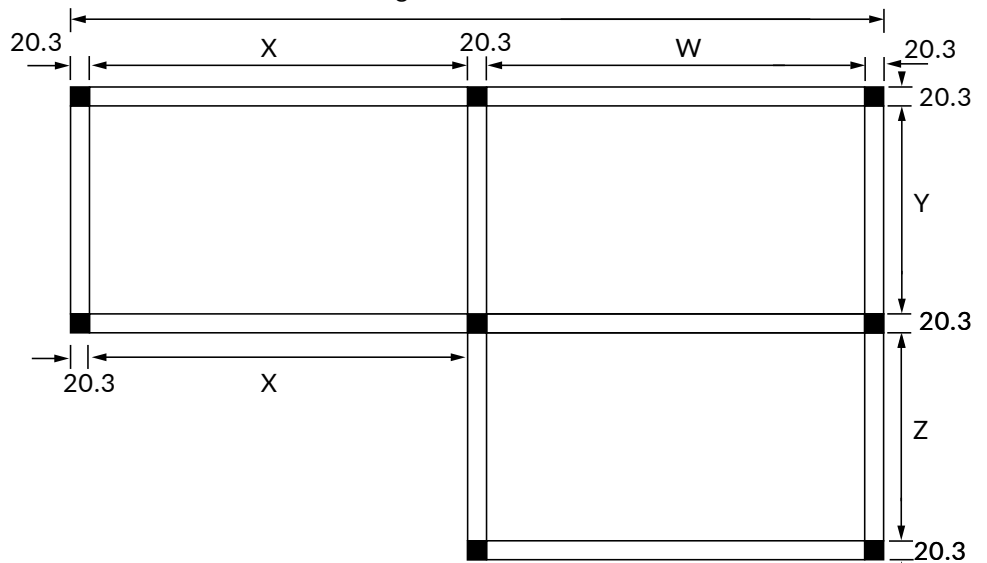

Hauteur totale = 20.3+Y+20.3+Z+20.3
Total height

A	CON-FLO-3D-TYPEA-NM
B	CON-FLO-3D-TYPEB-NM
C	CON-FLO-4D-TYPEC-NM
D	CON-FLO-4D-TYPED-NM
E	GAB-FLO
F	EQU-FLO-FIXMUR
G	CON-FLO-5D-NM
H	BOM-FLO-NM
J	PRO-FLO-TYPEA-NM
K	PRO-FLO-TYPEB-NM
L	SUP-FLO-TAB

Dimensions pour tablettes de bois ou de verre
Dimensions for wood or glass shelves

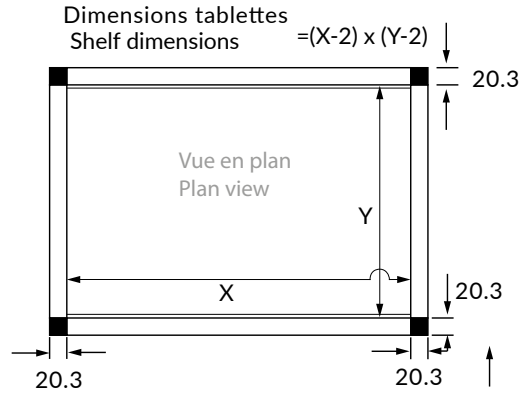
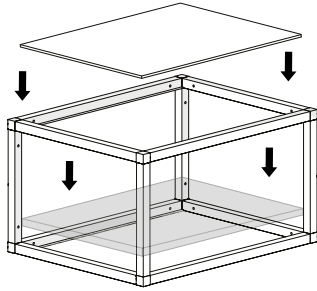

Espaceurs pour tablettes de 8 à 16 mm d'épaisseur
Spacers for shelf thickness from 8 to 16 mm

(L) SUP-FLO-TAB

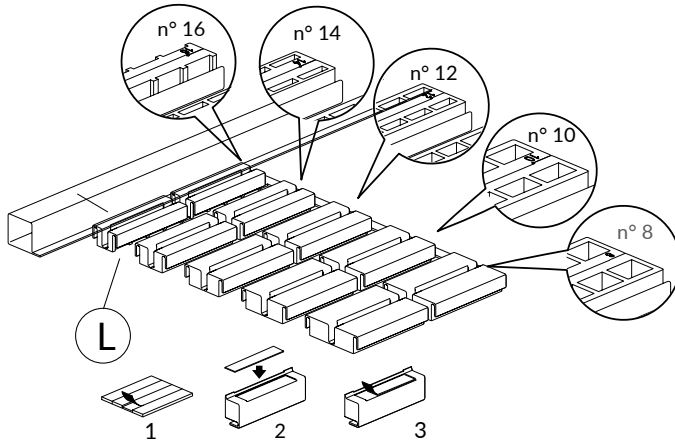

n°	Tablette / shelf (T)
8	8 mm
10	10 mm
12	12 mm
14	14 mm
16	16 mm

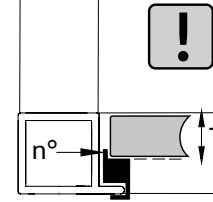

Espaceurs pour tablettes de verre 4 mm et 5mm.
Spacers for 4 mm and 5 mm glass shelves

(M) SUP-FLO-TABVERRE-4MM
(M) SUP-FLO-TABVERRE-5MM

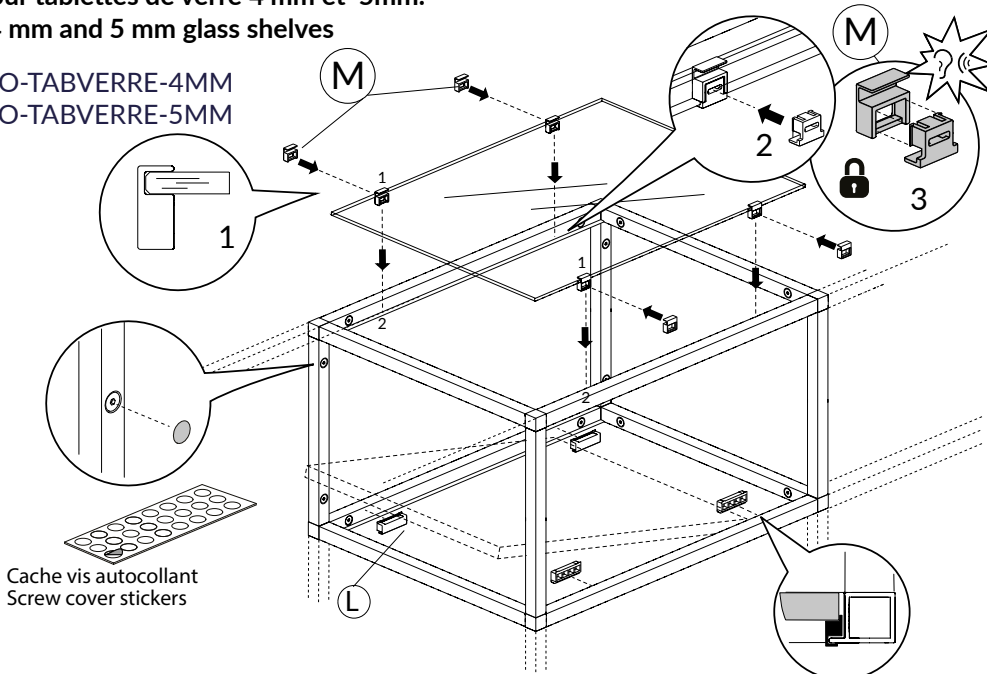

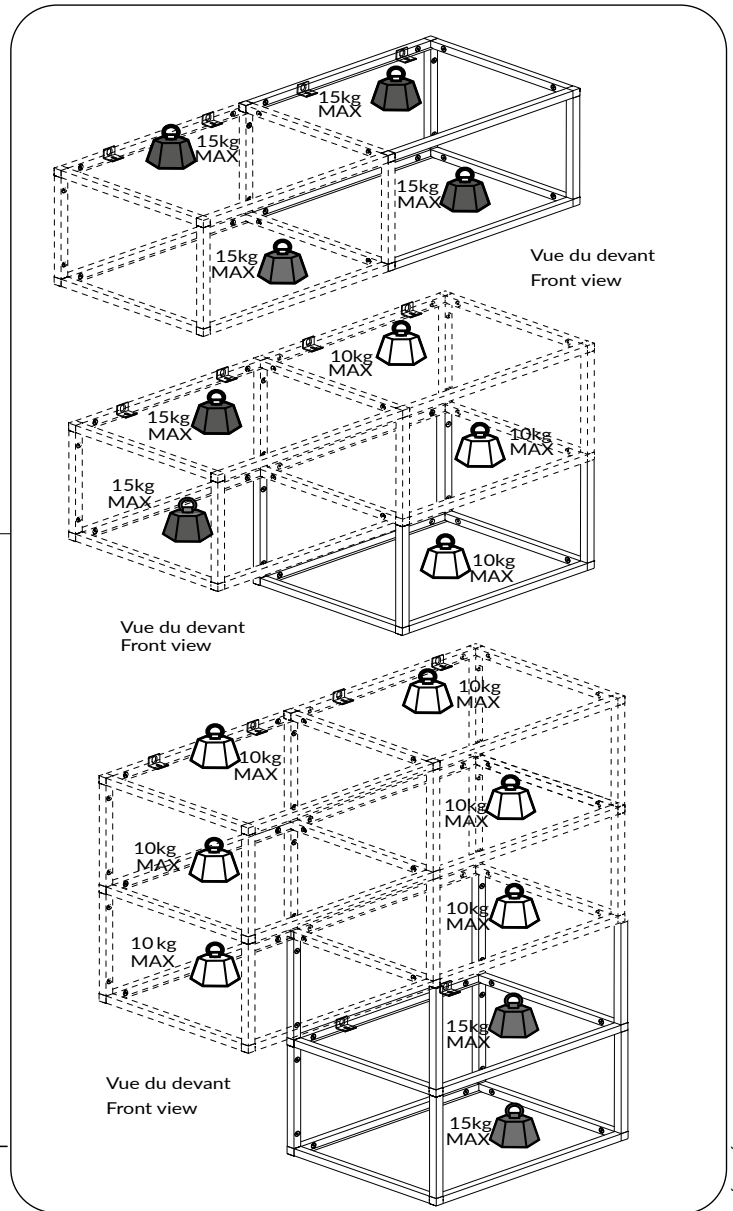
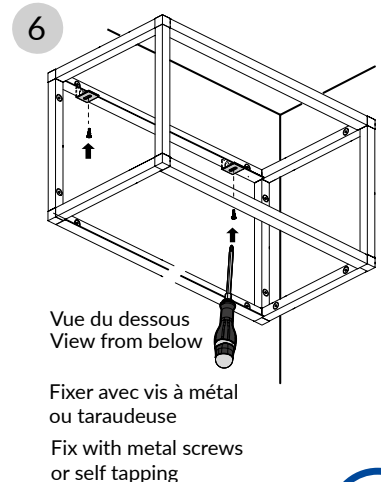
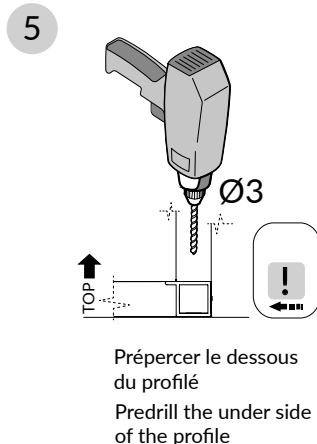
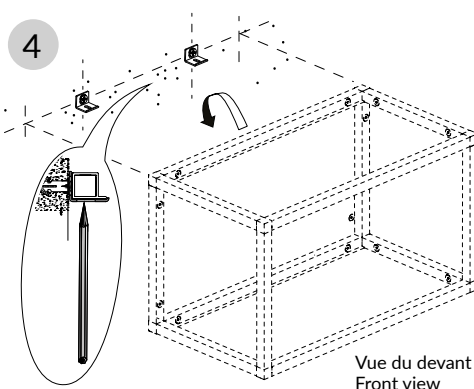
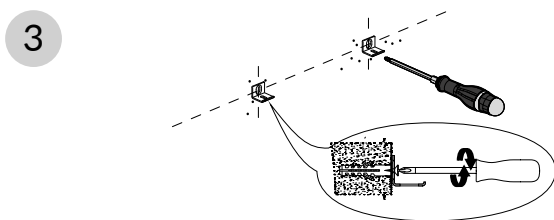
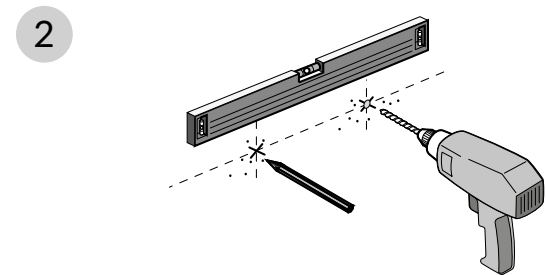
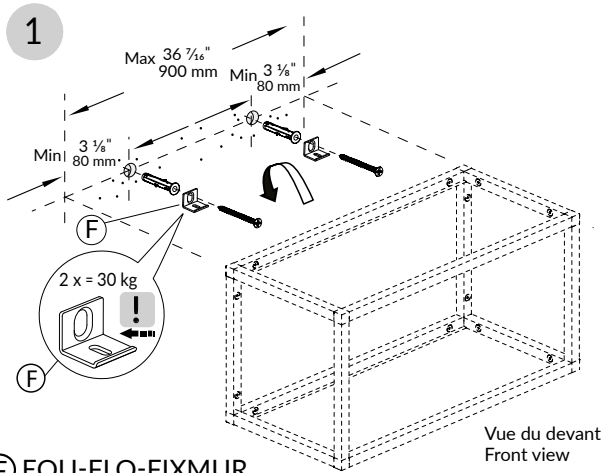

Connecteur 1D et 2D avec niveleur
1D and 2D connectors with leveller

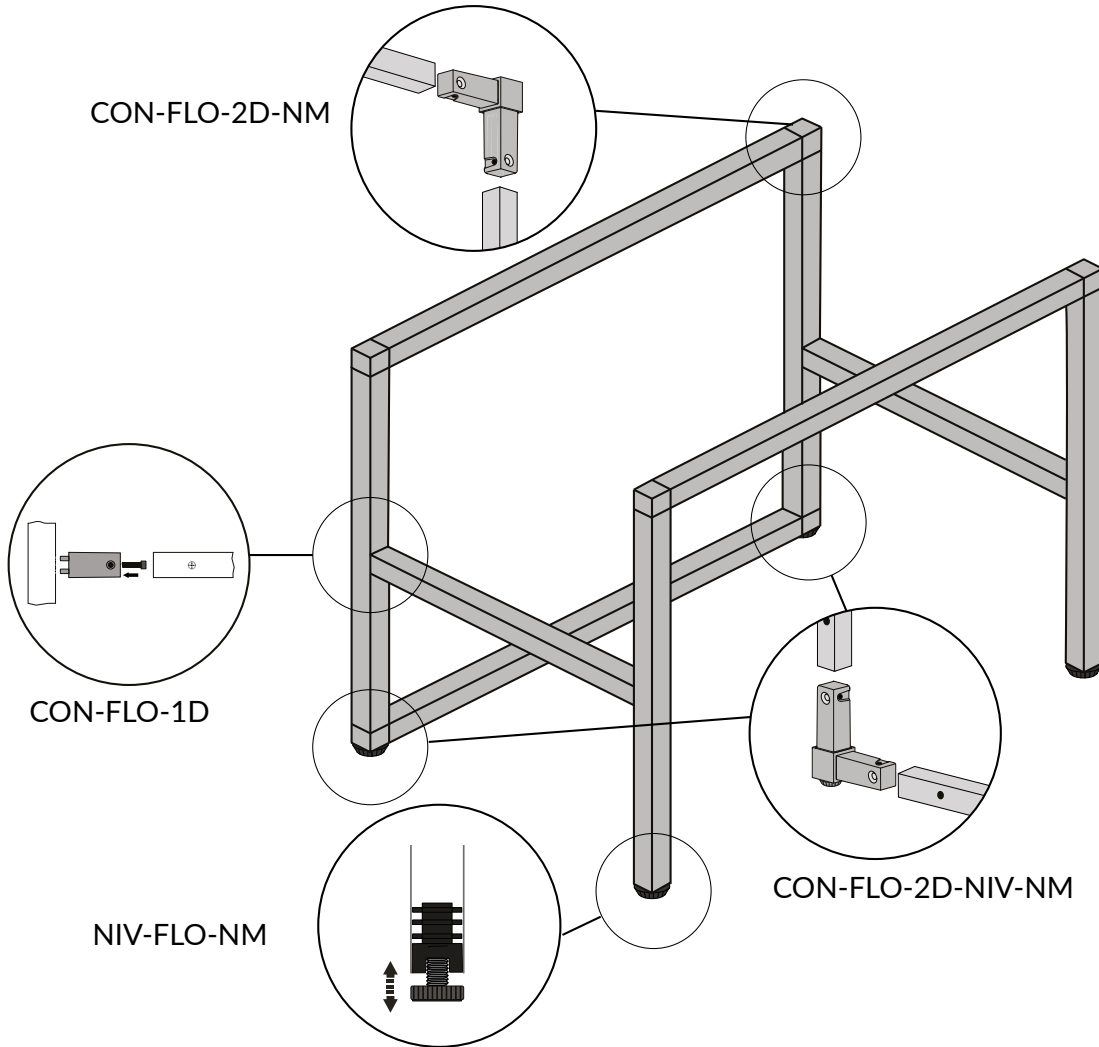

Perçage et assemblage du connecteur 1D Drilling and mounting of the 1D connector

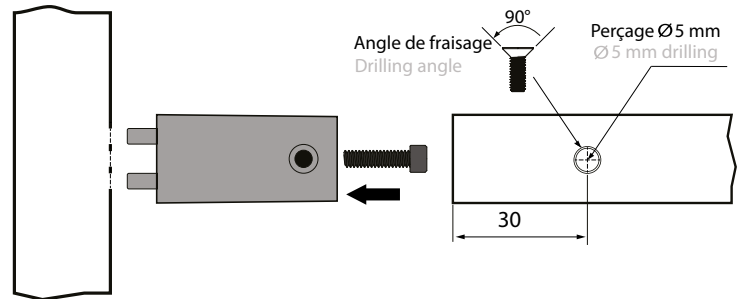
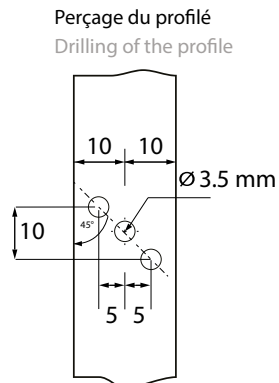

Marquer les profils avec le gabarit et un crayon pour établir l'emplacement du perçage.

Mark the location of the drilling with a pencil and the marking jig.

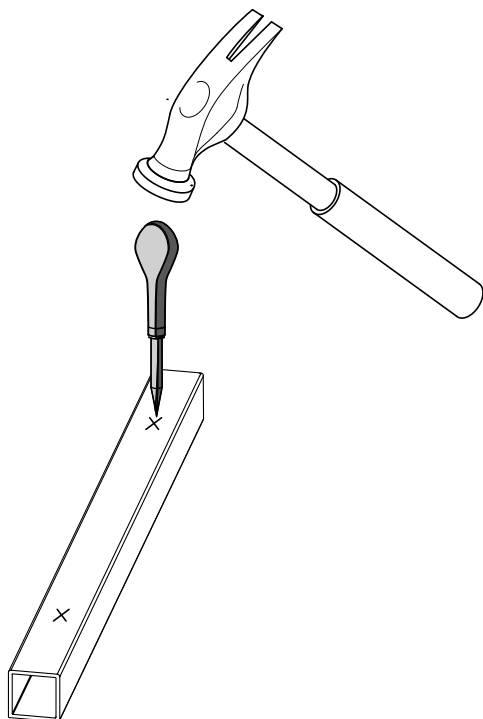
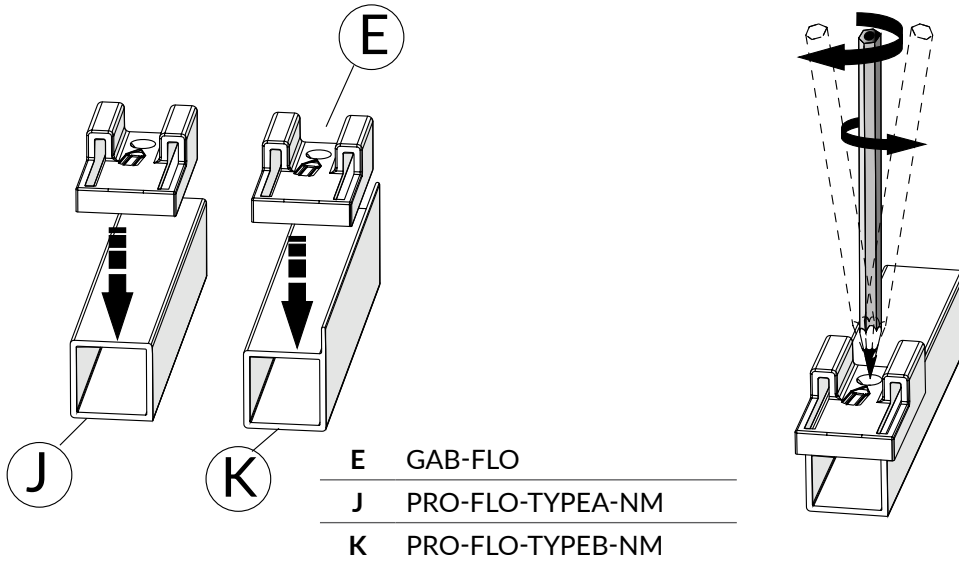

Marquer l'endroit du perçage à l'aide d'un poinçon.

Mark the drilling location with a puch.

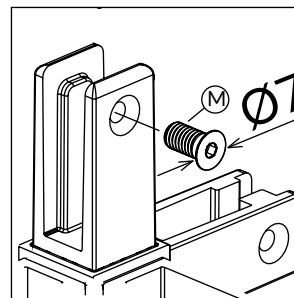
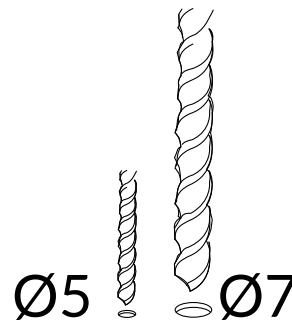

Percer un trou de 5 mm, fraiser ensuite pour la tête de la vis 7 mm.

Drill the 5 mm hole followed by the 7 mm chamfer for the screw head.

